

Modular Cooking Range Line
thermaline 90 - 2x5 lt Wells Freestanding
Electric Deep Fat Fryer, 1 Side H=800

ITEM # _____

MODEL # _____

NAME # _____

SIS # _____

AIA # _____



589455 (MCFBFADDAO)

5+5lt electric deep fat fryer,
one-side operated

Short Form Specification

Item No. _____

Unit constructed according to DIN 18860_2 with 20 mm drop nose top and 70 mm recessed plinth. Internal frame for heavy duty sturdiness in 2 mm and 3 mm in 1.4301 (AISI 304). 2 mm top in 1.4301 (AISI 304). Flat surface construction, easily cleanable. THERM

Main Features

- All major components may be easily accessed from the front.
- THERMODUL connection system creates a seamless work top when units are connected to each other thus avoiding soil penetrating vital components and facilitating the removal of units in case of replacement or service.
- Metal knobs with embedded hygienic silicon "soft" grip for easier handling and cleaning. The special design of the controls prevent infiltration of liquids or soil into vital components.
- Overheat protection: a temperature sensor switches off the supply in case of overheating.
- Large visible digital display manufactured in tempered glass to resist heat and chemicals, showing temperatures or power settings. The display also shows on/off status of the appliance and on/off status of the heating elements.
- Raised edge all around the well to protect from infiltration of dirt from worktop.
- Large overflow stamped area, located around the well. The 4 pre set programs can be adjusted by the user. The programmable parameters are: top plate temperature (trb)-bottom plate temperature (trb)-total duration of each cycle (tCYx)-duration of microwaves within each cycles (tW)
- Reduced power setting to melt solid fat.
- Oil level mark for MAX/MIN filling.
- Designed for deep fat frying of meat, fish, specialities and vegetable (french fries, chips).
- Oil can be drained off via a ball-valve with a lock to prevent unintentional opening. When opened, the ball valve provides a full cross-section opening to easily clean the drainage system.
- Electronic sensor for precise oil temperature control.
- Direct oil heating system with electric elements inside the frying well.

Construction

- 2 mm top in 1.4301 (AISI 304).
- Unit constructed according to DIN 18860_2 with 20 mm drop nose top and 70 mm recessed plinth.
- Flat surface construction with minimal hidden areas to easily clean all surfaces
- IPX5 water resistance certification.
- Internal frame for heavy duty sturdiness in stainless steel.

Sustainability



- Standby function for energy saving and fast recovery of maximum power.
- [NOT TRANSLATED]

APPROVAL: _____



Electrolux
PROFESSIONAL

Modular Cooking Range Line thermaline 90 - 2x5 lt Wells Freestanding Electric Deep Fat Fryer, 1 Side H=800

Front

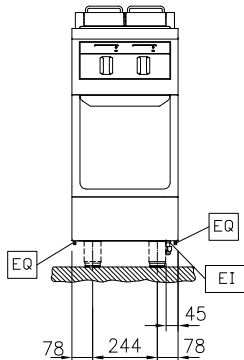

Side

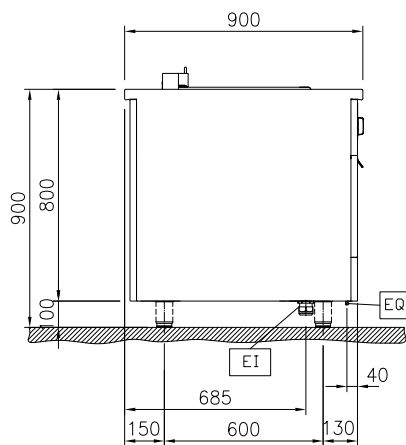

EI = Electrical inlet (power)
EQ = Equipotential screw

Top

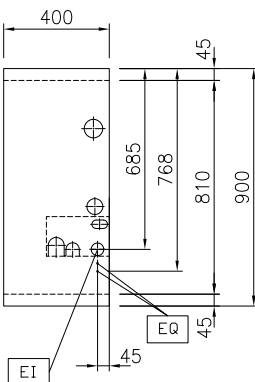

Electric

Supply voltage: 400 V/3N ph/50/60 Hz
Total Watts: 12 kW

Key Information:

Number of wells: 2
Usable well dimensions (width): 140 mm
Usable well dimensions (height): 230 mm
Usable well dimensions (depth): 345 mm
Well capacity: 4 lt MIN; 5 lt MAX
Thermostat Range: 100 °C MIN; 180 °C MAX
External dimensions, Width: 400 mm
External dimensions, Depth: 900 mm
External dimensions, Height: 800 mm
Net weight: 65 kg
Configuration: On Base; One-Side Operated

Sustainability

Current consumption: 17.3 Amps



Modular Cooking Range Line
thermaline 90 - 2x5 lt Wells Freestanding Electric Deep Fat Fryer, 1 Side
H=800

The company reserves the right to make modifications to the products without prior notice. All information correct at time of printing.

2025.05.08

Included Accessories

- 1 of 2 baskets for 2x5lt deep fat fryer PNC 913035
- 2 of Filter for 2x5 and 7lt deep fat fryer oil collection basin PNC 913154

Optional Accessories

- Connecting rail kit, 900mm PNC 912502 ☐
- Stainless steel side panel (12mm), 900x800mm, freestanding PNC 912511 ☐
- Portioning shelf, 400mm width PNC 912522 ☐
- Portioning shelf, 400mm width PNC 912552 ☐
- Folding shelf, 300x900mm PNC 912581 ☐
- Folding shelf, 400x900mm PNC 912582 ☐
- Fixed side shelf, 200x900mm PNC 912589 ☐
- Fixed side shelf, 300x900mm PNC 912590 ☐
- Fixed side shelf, 400x900mm PNC 912591 ☐
- Stainless steel front kicking strip, 400mm width PNC 912594 ☐
- Stainless steel side kicking strips left and right, freestanding, 900mm width PNC 912621 ☐
- Stainless steel side kicking strips left and right, back-to-back, 1800mm width PNC 912627 ☐
- Stainless steel plinth, freestanding, 400mm width PNC 912916 ☐
- Connecting rail kit, right PNC 912975 ☐
- Connecting rail kit, left PNC 912976 ☐
- Endrail kit, flush-fitting, left PNC 913111 ☐
- Endrail kit, flush-fitting, right PNC 913112 ☐
- Endrail kit (12mm) for thermaline 90 units, left PNC 913202 ☐
- Endrail kit (12mm) for thermaline 90 units, right PNC 913203 ☐
- Stainless steel side panel, left, H=800, flush PNC 913224 ☐
- Stainless steel side panel, left, H=800, flush PNC 913225 ☐
- T-connection rail for back to back installations without backsplash PNC 913227 ☐
- - NOT TRANSLATED - PNC 913232 ☐
- - NOT TRANSLATED - PNC 913245 ☐
- - NOT TRANSLATED - PNC 913251 ☐
- - NOT TRANSLATED - PNC 913252 ☐
- - NOT TRANSLATED - PNC 913255 ☐
- - NOT TRANSLATED - PNC 913256 ☐
- - NOT TRANSLATED - PNC 913259 ☐
- - NOT TRANSLATED - PNC 913277 ☐
- - NOT TRANSLATED - PNC 913278 ☐
- - NOT TRANSLATED - PNC 913663 ☐
- - NOT TRANSLATED - PNC 913673 ☐
- - NOT TRANSLATED - PNC 913676 ☐
- - NOT TRANSLATED - PNC 913689 ☐